

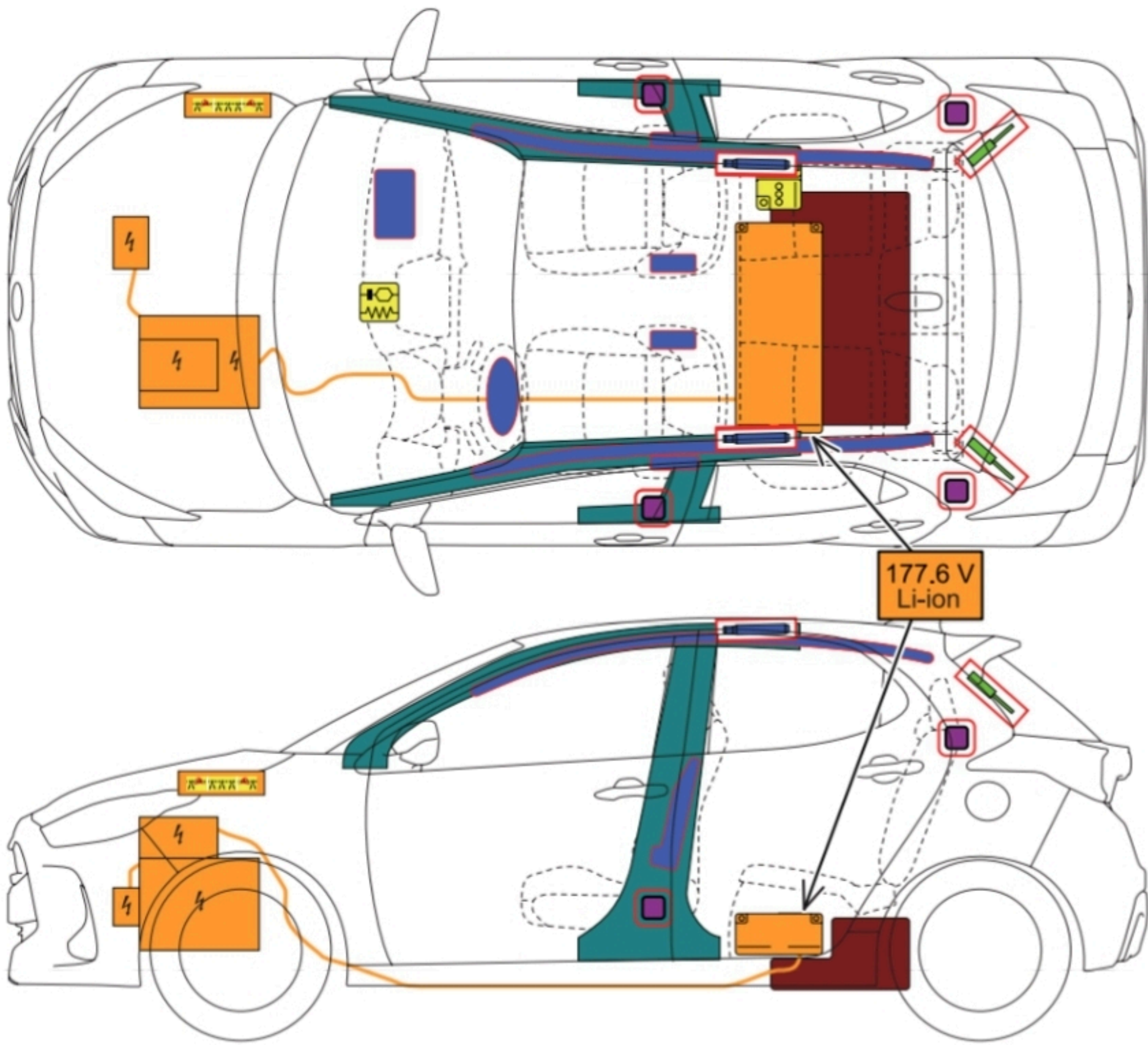

TOYOTA YARIS HYBRID
5 doors / 5 seats / hatchback
2024-4



| | | | | | | | | | |
|-----------|--------------------------|-------------|---------------------|--------------|------------------------|-------|---------------------------|--|------------------------------|
| | Airbag | | Stored gas inflator | | Seat belt pretensioner | | SRS control unit | | Gas strut / Preloaded spring |
| | High strength zone | | Battery low voltage | | Fuel tank | | High voltage battery pack | | High voltage component |
| | High voltage power cable | | Cable Cut | | | | | | |
| | | | | | | | | | |
| | | | | | | | | | |
| ID No. | | Version No. | | Version date | | Page | | | |
| YARISHV10 | | 03 | | 05 / 2025 | | 1 / 4 | | | |

1. Identification / Recognition

 LACK OF ENGINE NOISE DOES NOT MEAN VEHICLE IS OFF. SILENT MOVEMENT OR INSTANT RESTART CAPABILITY EXISTS UNTIL VEHICLE IS FULLY SHUT DOWN.

■ Location of vehicle badges

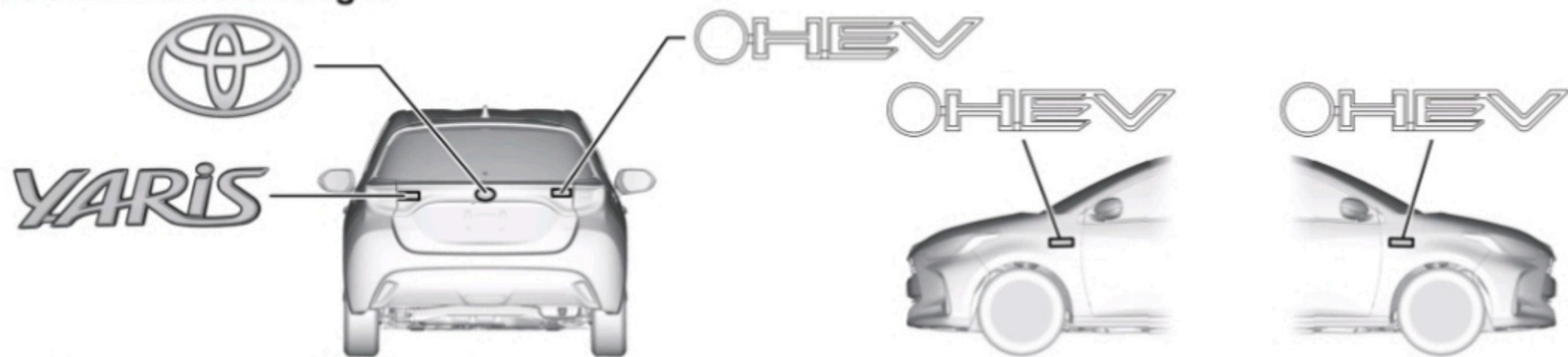

■ Energy source: Lithium-ion battery



2. Immobilisation / Stabilisation / Lifting

■ Completely immobilize the vehicle

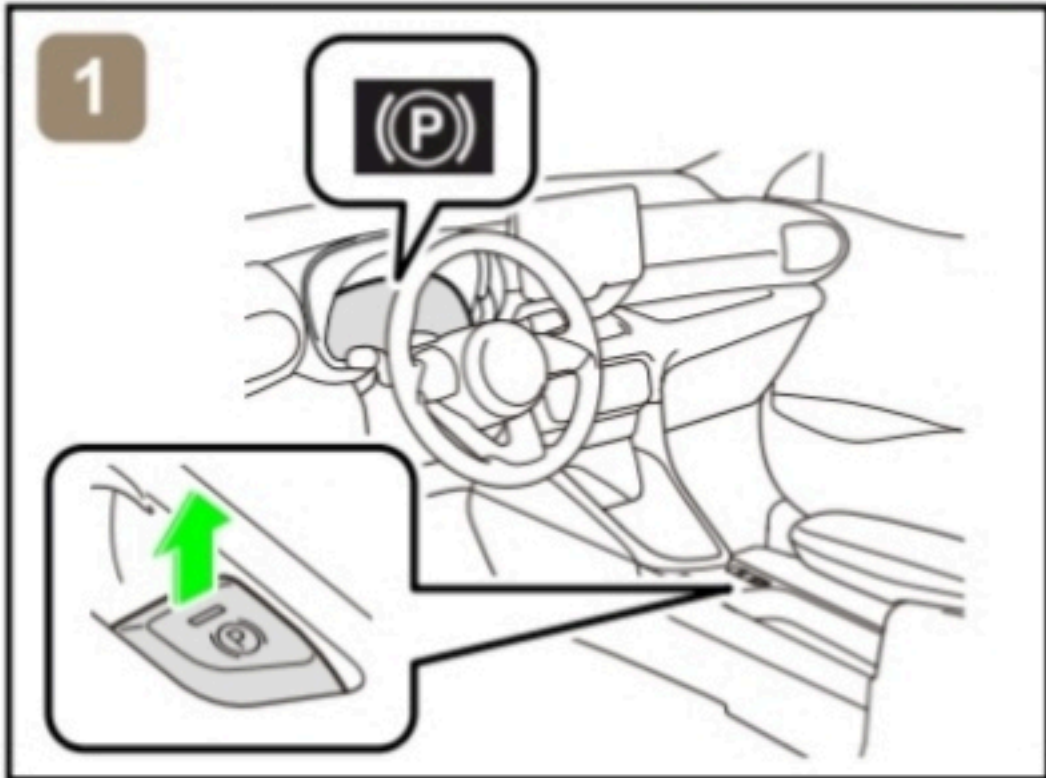

1. Chock the wheels and engage the parking brake.

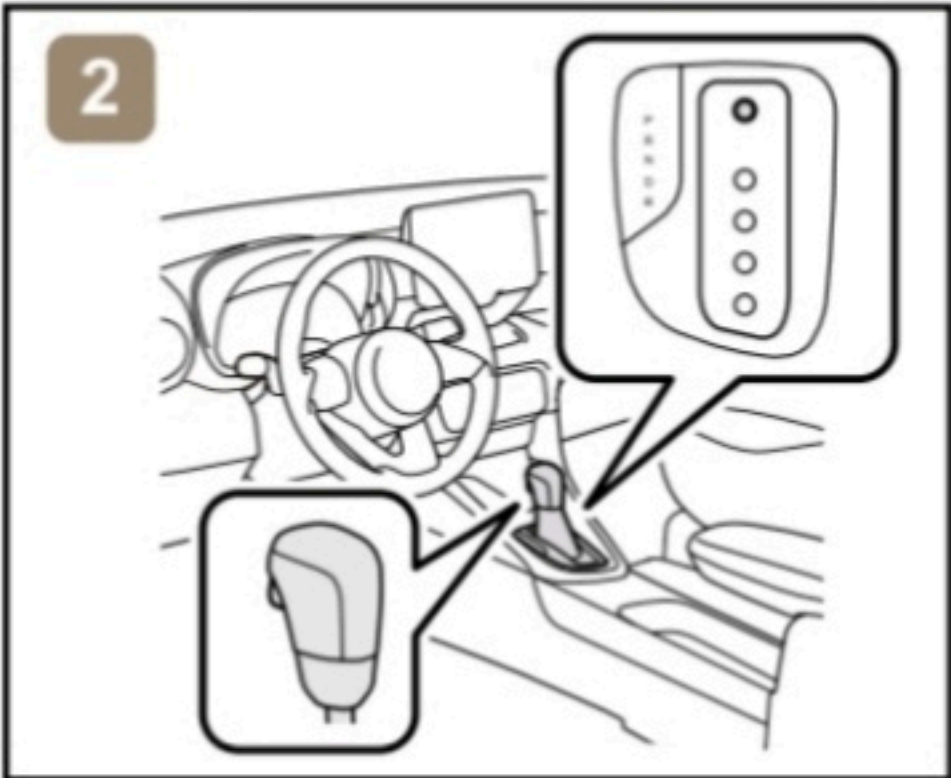

2. Move the shift lever to the park (P) position.

■ Stabilisation-lifting point

Place cribbing such as wooden blocks at the four points under the front and rear pillars.

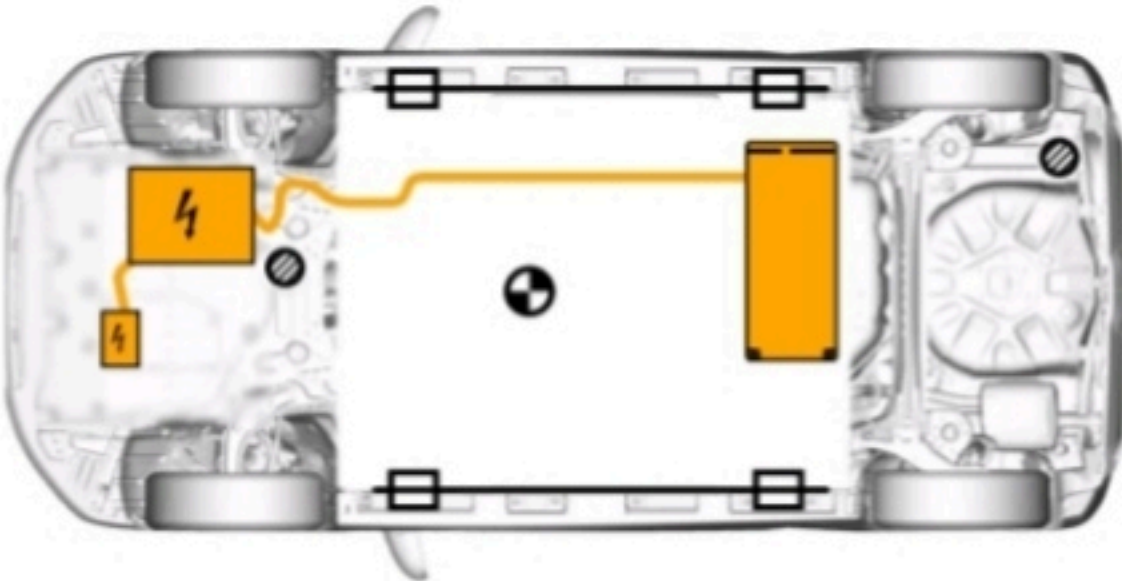

 Extra Reinforced Lifting Points  Standard Jack Locations  Vehicle Center of Gravity

 DO NOT PLACE CRIBBING SUCH AS WOODEN BLOCKS OR RESCUE AIR LIFTING BAGS UNDER THE EXHAUST SYSTEM, FUEL SYSTEM OR HIGH VOLTAGE POWER CABLES. DOING SO MAY RESULT IN FUEL LEAKS, FIRE, OR ELECTRIC SHOCK.

3. Disable direct hazards / Safety regulations

■ If any of the following systems are required to be operated, operate them BEFORE disconnecting the battery.

Power door lock Power window Back door opener
Electric parking brake

When the 12 V battery is disconnected, electrical components cannot be operated.

| | | | | |
|--|-----------|-------------|--------------|-------|
| | ID No. | Version No. | Version date | Page |
| | YARISHV10 | 03 | 05 / 2025 | 2 / 4 |

■ Perform procedure Main or Alternative to completely shut off the vehicle.

<Main Procedure>

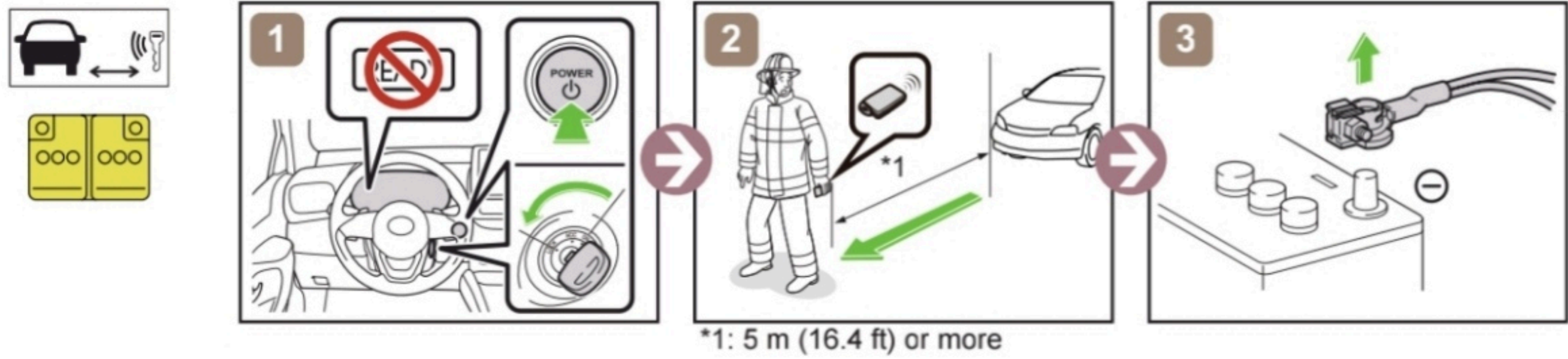

<Alternative Procedure>

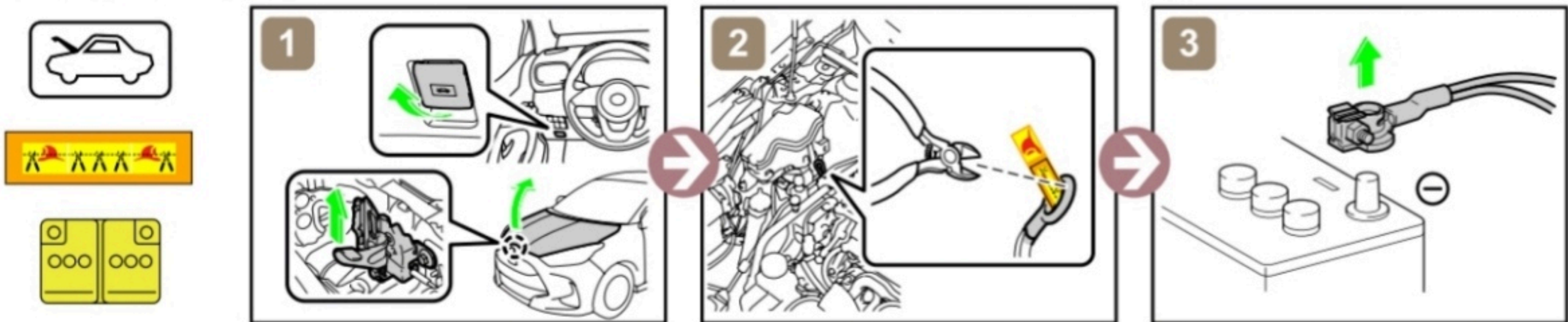

In the event of an accident in which the airbags are deployed, the high-voltage system will be automatically deactivated.

■ Access to 12 V Battery

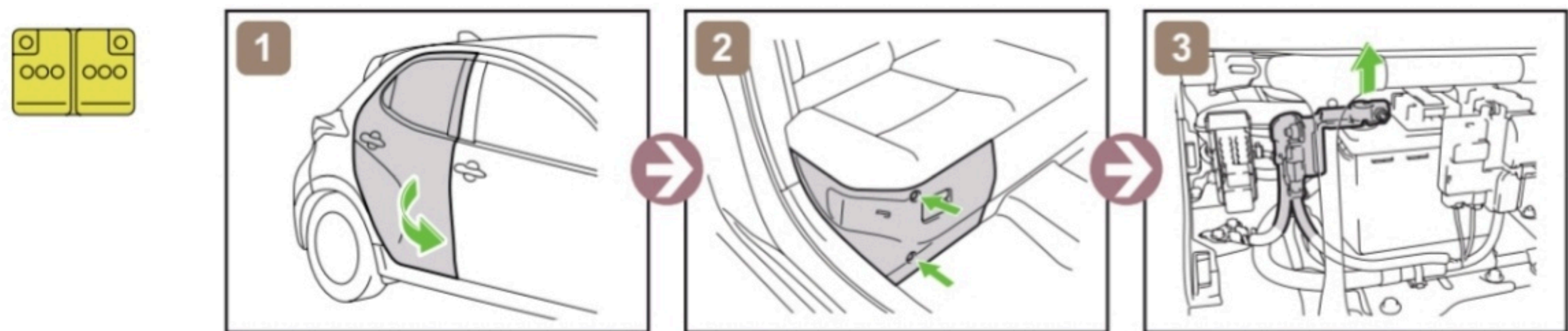

4. Access to the occupants

■ Window Glass

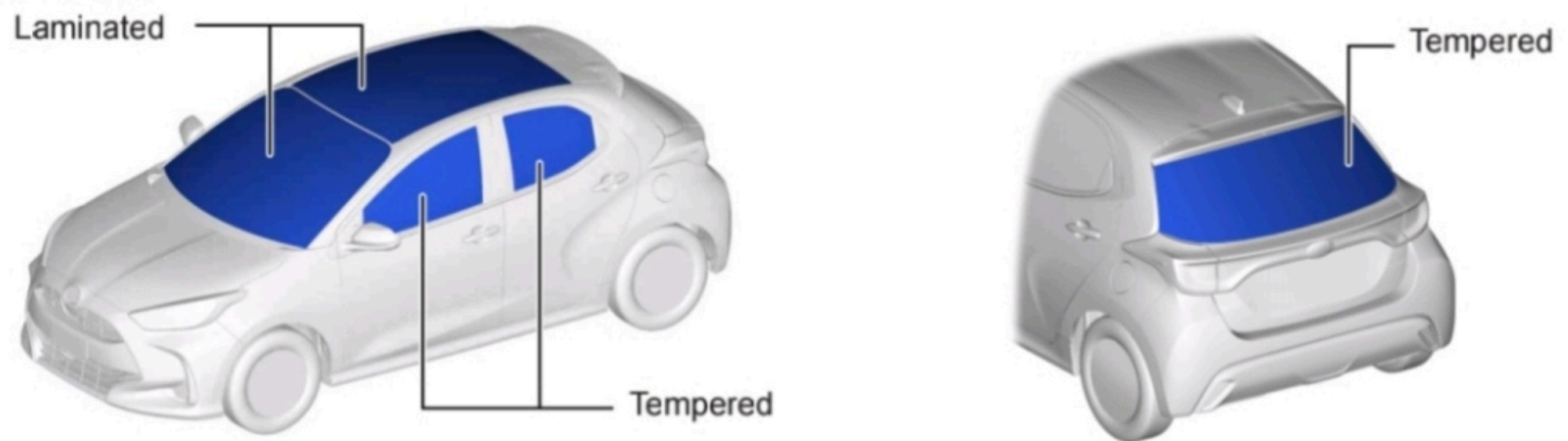

5. Stored energy / Liquids / Gases / Solids



High Voltage Li-ion Battery: 177.6 V

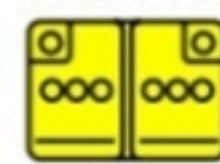

Low Voltage Battery: 12 V

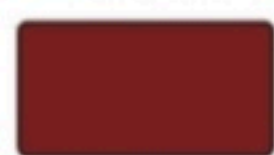

Gasoline Tank: 36 L, 33 L



Air Conditioner Refrigerant Gas

| ID No. | Version No. | Version date | Page |
|-----------|-------------|--------------|-------|
| YARISHV10 | 03 | 05 / 2025 | 3 / 4 |



- ALWAYS WEAR APPROPRIATE PERSONAL PROTECTIVE EQUIPMENT (PPE) WHEN DEALING WITH ANY OF THESE ITEMS.
- NEVER BREACH OR REMOVE THE BATTERY ASSEMBLY COVER UNDER ANY CIRCUMSTANCES, INCLUDING FIRE. DOING SO MAY RESULT IN SERIOUS INJURY OR DEATH FROM SEVERE BURNS OR ELECTRIC SHOCK.

6. In case of fire



USE COPIOUS AMOUNTS OF WATER

If it is difficult to apply copious amounts of water to the high voltage battery, it is recommended to allow the high voltage battery to burn itself out.



RE-IGNITION POSSIBLE !

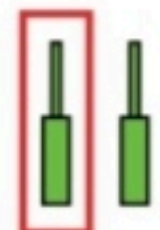

Gas strut / Preloaded spring
As it is possible for a gas strut / preloaded spring to become a projectile, refer to the component layout drawing.

7. In case of submersion



DO NOT TOUCH ANY OF THE HIGH-VOLTAGE COMPONENTS OR CABLES, INCLUDING THE SERVICE PLUG, WHILE THE VEHICLE IS SUBMERGED. DOING SO MAY RESULT IN ELECTRIC SHOCK. WORK ON THE VEHICLE ONLY AFTER THE VEHICLE HAS BEEN PULLED OUT OF THE WATER.

8. Towing / Transportation / Storage

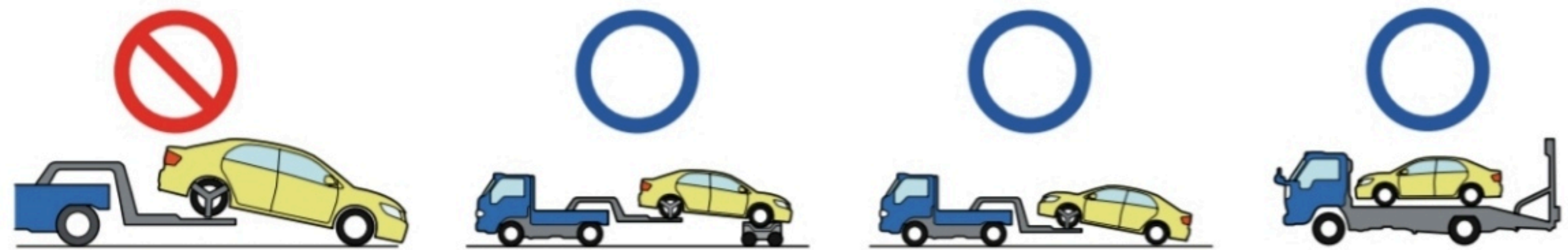

RE-IGNITION POSSIBLE !

Store the vehicle at a safe distance (15 m (49.2 ft) or more) from other vehicles.

9. Important additional information

For further details, please refer to "Emergency Response Guide".
<http://www.toyota-tech.eu>

| | | | | |
|--|-----------|-------------|--------------|-------|
| | ID No. | Version No. | Version date | Page |
| | YARISHV10 | 03 | 05 / 2025 | 4 / 4 |