

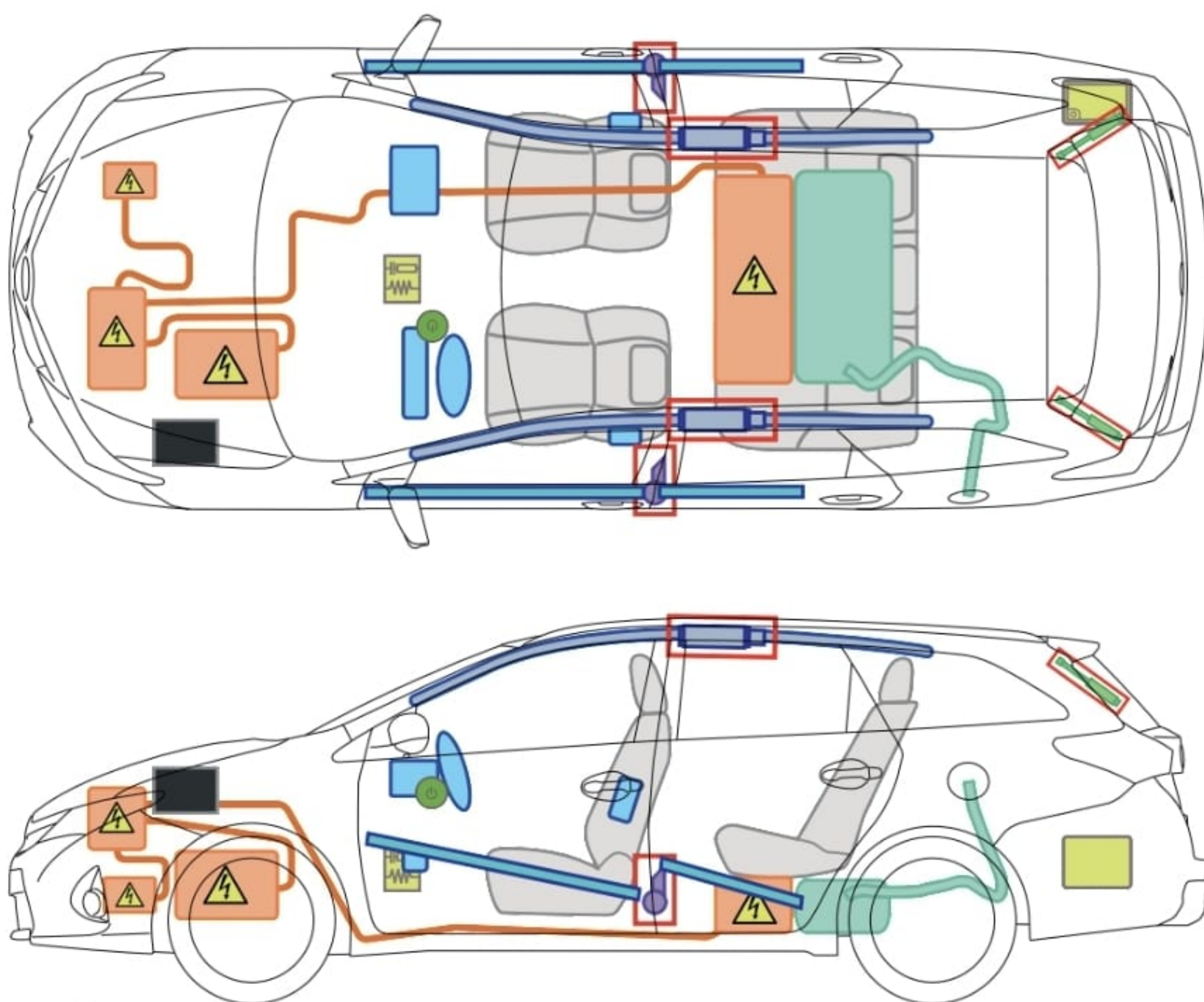













Toyota Auris Touring Sports



Toyota Auris TS Hybrid
(HE15U(a), ab 6/2013)



Legende

	Zündschalter		Sicherungs- kasten		12 Volt- Batterie
	Airbag		Gas- generator		Hochvolt- bauteile
	Kraftstoff- tank		Gasdruck- dämpfer		Gurtstraffer
	Karosserie- verstärkung		Steuergerät		



Besonderheiten:

Hochvoltanlage mit Gleichspannung bis 210 Volt und Wechselspannung bis 650 Volt! Hochvoltbauteile nicht berühren.
Erkennungsmerkmale und Details, siehe Rückseite!



Toyota Auris Touring Sports



Toyota Auris TS Hybrid
(HE15U(a), ab 6/2013)



12V Spannungsversorgung trennen

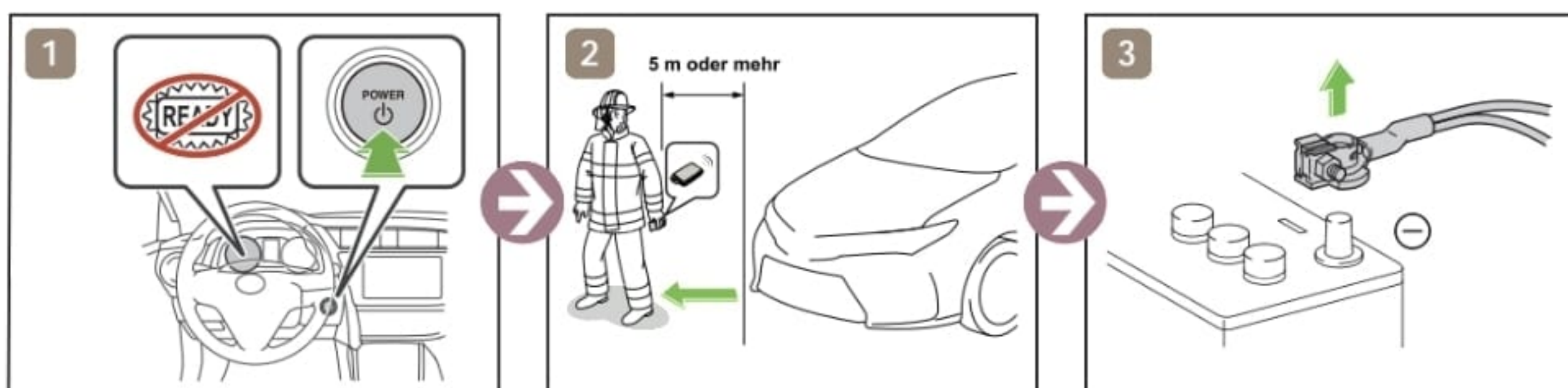

oder

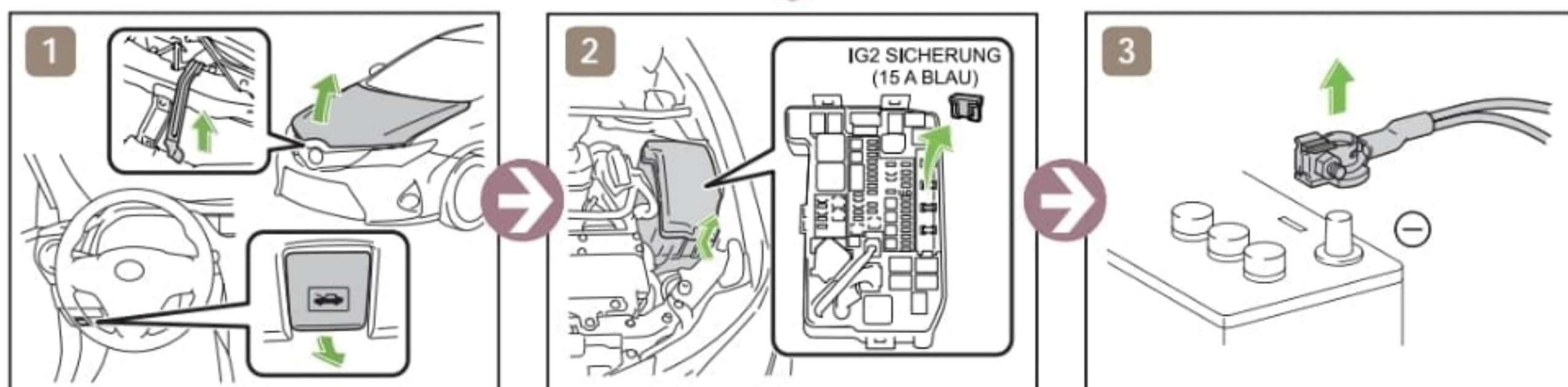

Zugang 12V Batterie

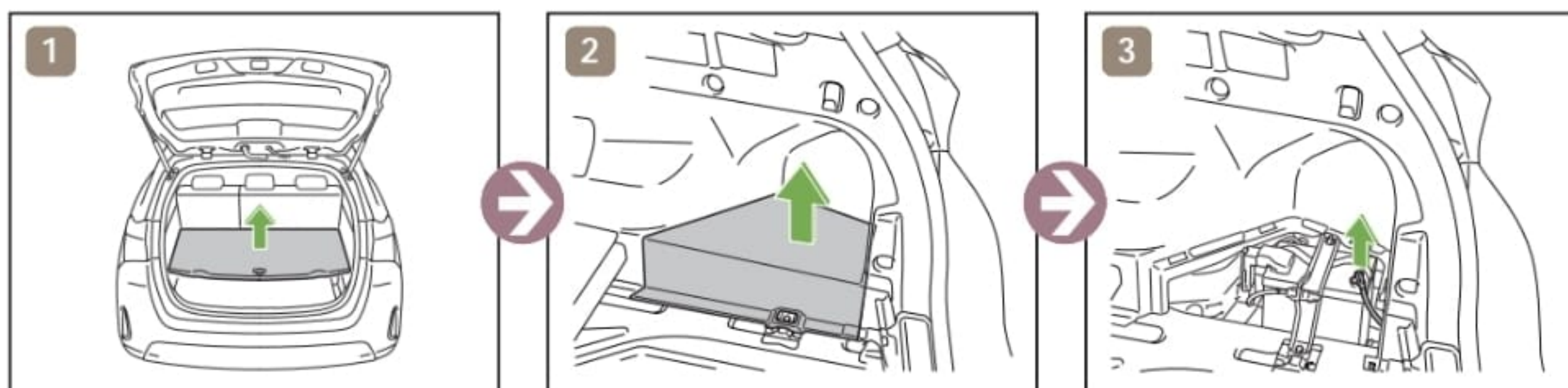

Hinweise zum Transport

